



Installation of Auto-Rotation Set

This is a Short Brief note on how to install the Auto rotation system

Step 1

Screws Used	
CM 2x4mm	4 pcs
Bearing Used	
-	-

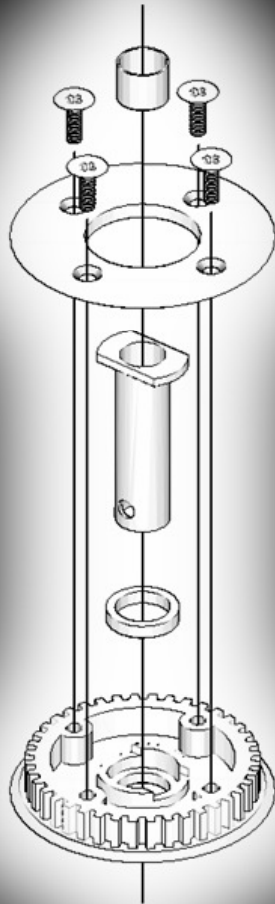

Note: When securing the cover of the Belt Gear, make sure it is not too tight and the lid is not deformed.

When inserting the copper ring and the inner sleeve, make sure the inner sleeve is fully inserted into the belt gear. This should give a flat surface on the top of the sleeve.



Installation of Auto-Rotation Set

Step 2

Screws Used	
CB 1.7x4mm	4 pcs
Bearing Used	
-	-

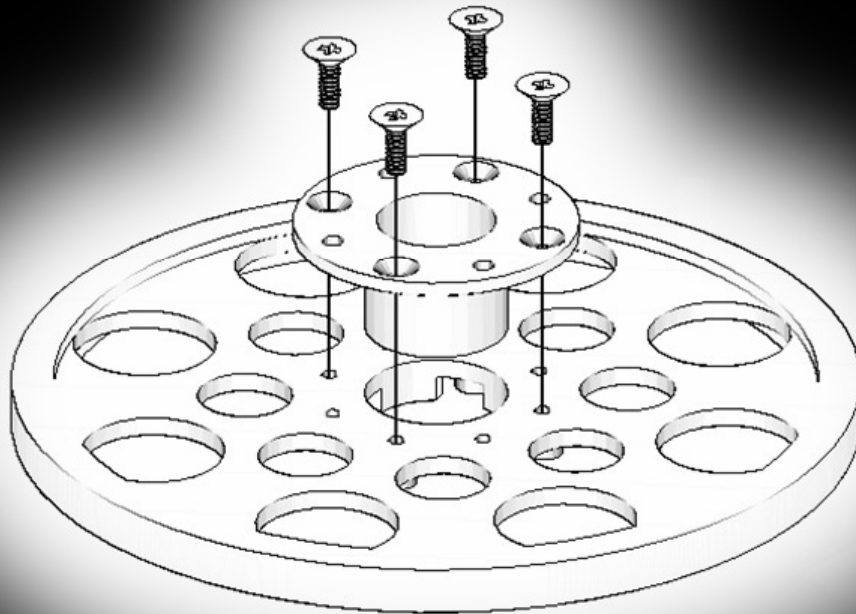

Note:

Remove the normal bearing mount and secure the one-way Bearing mount on the main gear.



Installation of Auto-Rotation Set

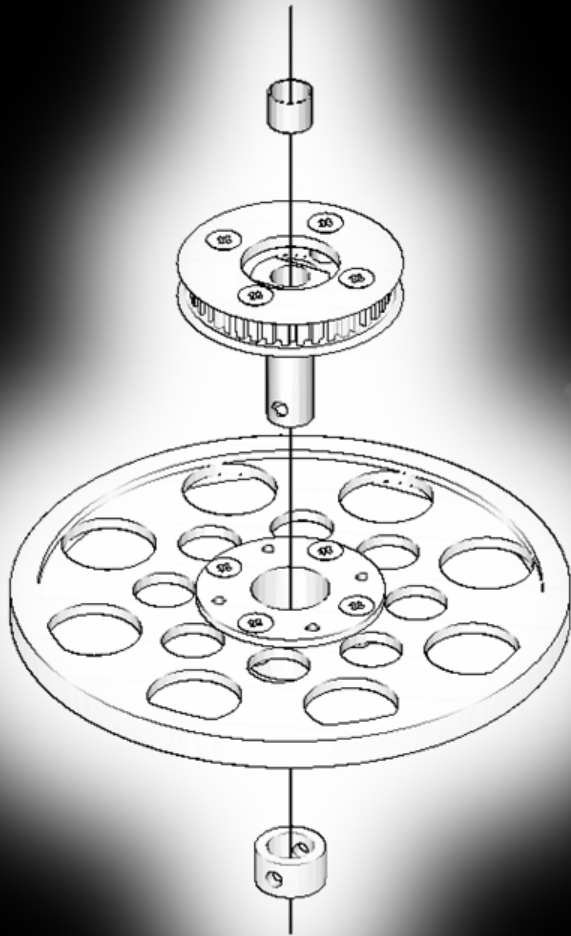

Insert the auto system to the main gear, then secure the collar at the bottom.

The belt gear should be able to rotate freely in single direction. If not, check if the inner sleeve is fully inserted.

The top spacer is recommended to be upgraded to GBT5125 Thrust bearing to have the best performance.