



GX3-4401/4 Manual

V1.0

# Xeon Series

## Fiber Frame

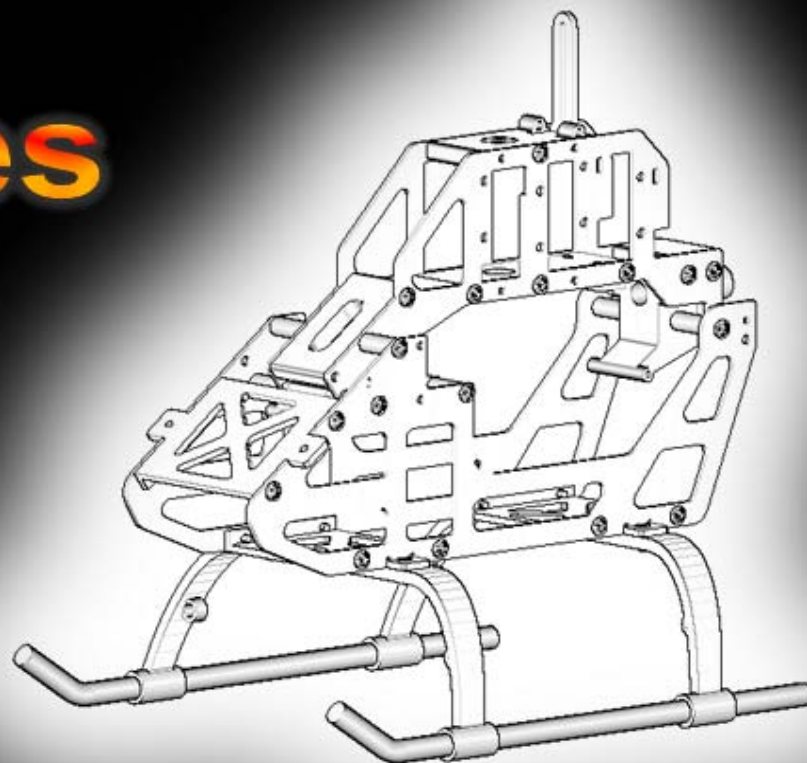



# Xeon Series

GX3-4401/4

## Fiber Frame

### Preface

Thanks for purchasing Guru-Z products. This Fiber Frame provides a durable and well-designed structure for 5mm tail rotor system, optimizing the performance of 300class helicopter. Please read the manual carefully before assembling the model. You may always get the latest online version of the manual via <http://www.guru-z.com/catalog/download.php>

### Key Features

- Provide a platform for pilot to use their own rotor head and modify to suit their needs
- Compatible with most of the 300class EP helicopter rotors in the market.
- Rigid Frame structure and strong Motor mount
- Durable and elastic landing skid

### Tools needed

- 1.5mm philip "+" head screwdriver
- 1.5mm Hex driver
- Plier
- Loctite
- Grease

### Notes on screws type

- Please use the screws carefully. Types of Screws used are shown below.

CB	HM	PWB	PM



# Xeon Series

GX3-4401/4

## Fiber Frame

### Step 1

Screws Used	
PWB 1.7 x7mm	2 pcs
Bearing Used	
3x8x2.5mm	1pc

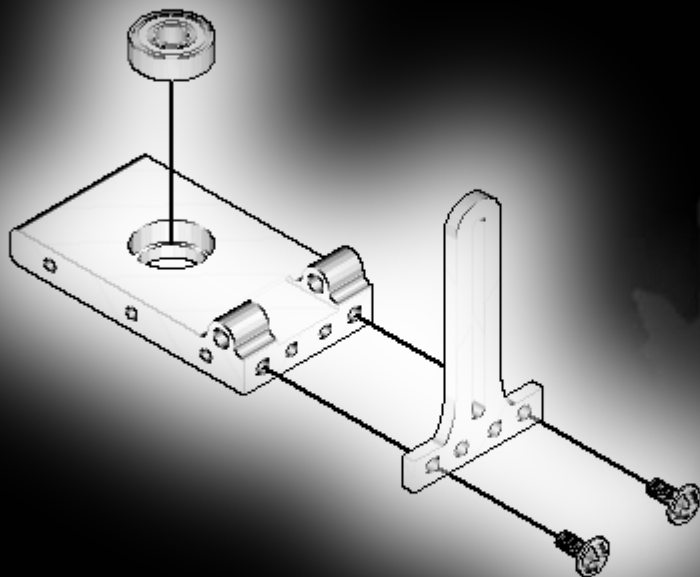

**Note:** Bearing is installed in the slot as shown in the diagram. Bearing size may varies according to different models.

The Swash holder is installed opposite to the stock version of the King.

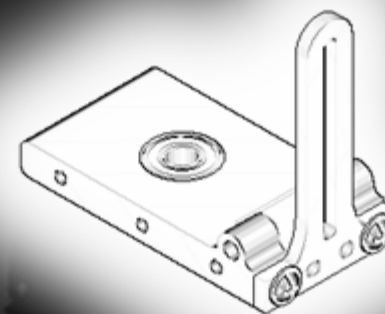



# Xeon Series

GX3-4401/4

## Fiber Frame

### Step 2

Screws Used	
-	-
Bearing Used	
3x8x2.5mm	1 pcs

**Note:** Install the bearing into the slot as shown in the diagram. Bearing size may varies according to different models.

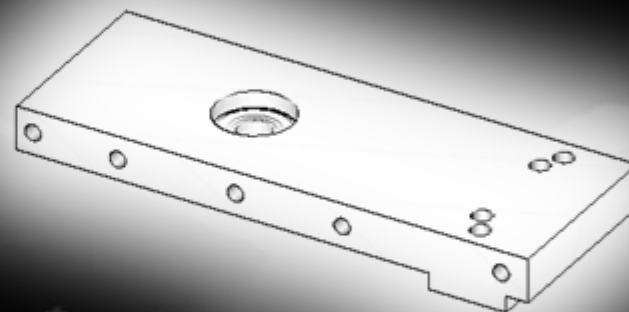
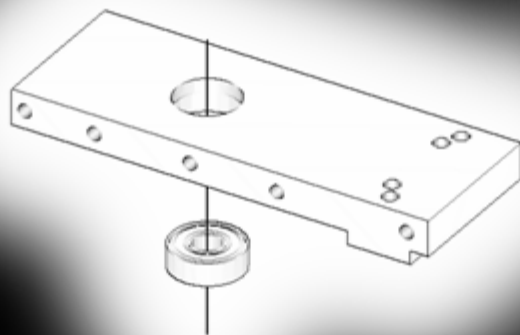





# Xeon Series

GX3-4401/4

## Fiber Frame

### Step 3

Screws Used	
-	-
Bearing Used	
-	-

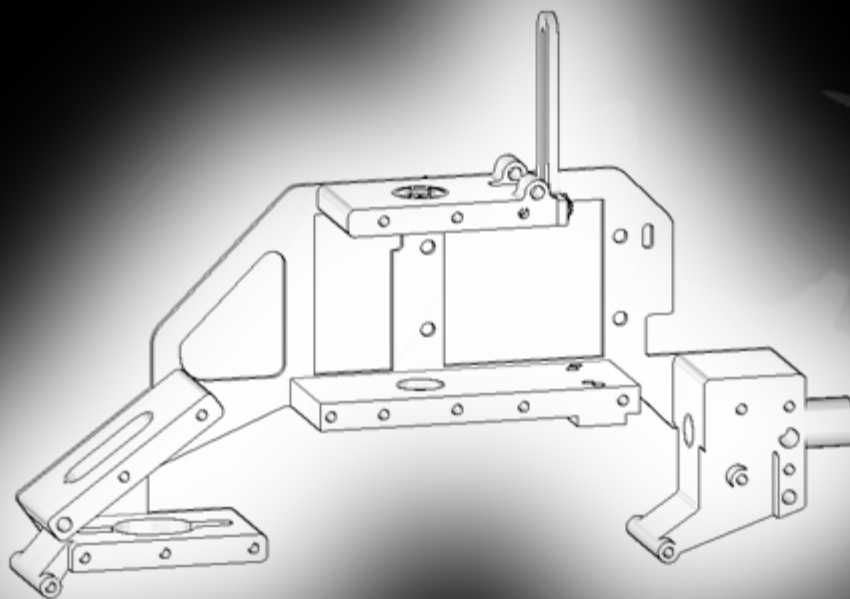

**Note:** Install the parts as shown in the diagram. NOT all holes need screws at this stage.

Install Servo at this stage is recommended.



# Xeon Series

GX3-4401/4

## Fiber Frame

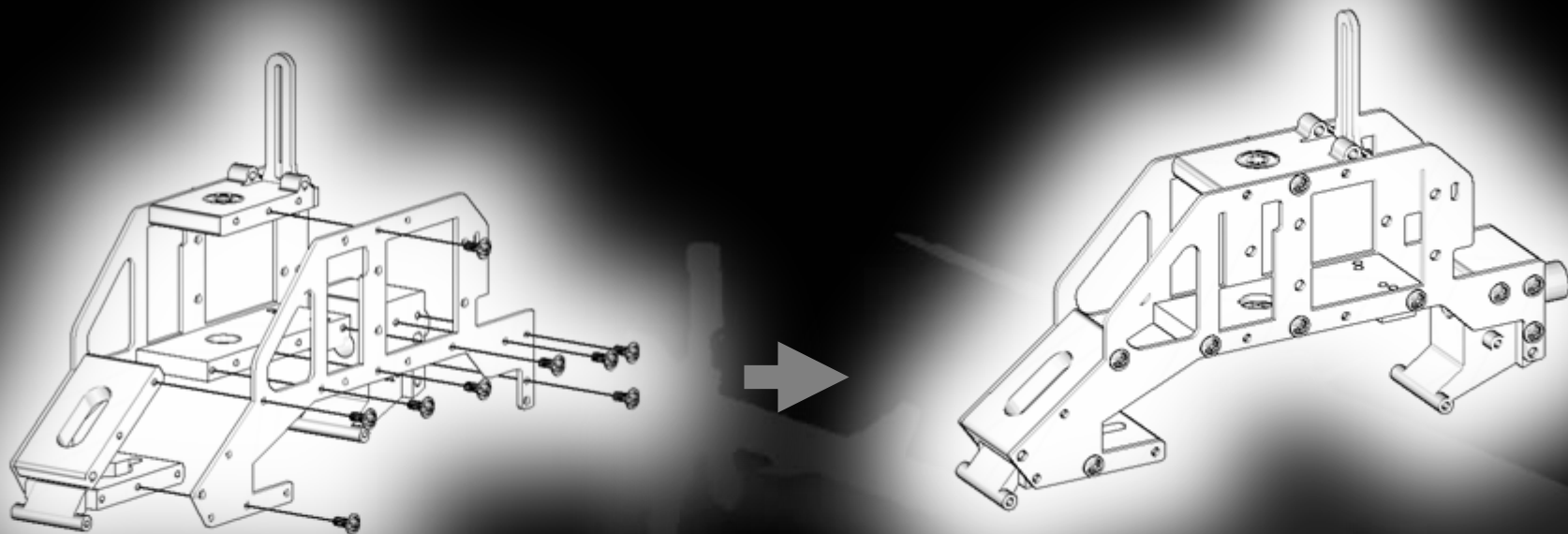

### Step 4

Screws Used	
PWB 1.7 x4mm	18 pcs
Bearing Used	
-	-

**Note:** If you plan to use a bigger motor, you should install the motor at the stage. Guru-Z GE38H Brushless motor are able to be installed after finishing the frame.



# Xeon Series

GX3-4401/4

## Fiber Frame

### Step 5

Screws Used	
PWB 1.7 x4mm	12 pcs
PWB 1.7 x14mm	8 pcs
Bearing Used	
-	-

**Note:** There are 2 kinds of inter-frame support. The 2 longer rods should be install at the rear part of the frame.

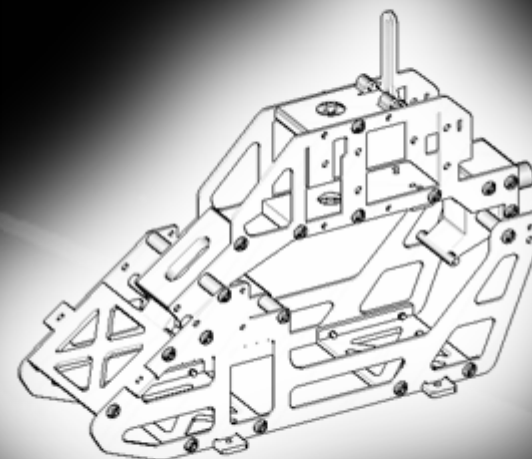
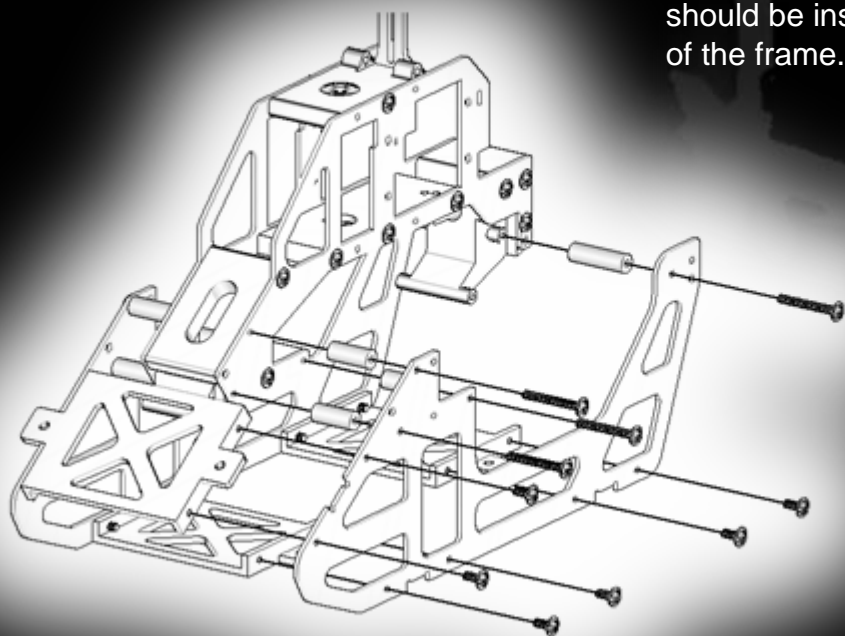



# Xeon Series

GX3-4401/4

## Fiber Frame

### Step 6

Screws Used	
CB 1.7 x7mm	4 pcs
Bearing Used	
-	-

**Note:** You may choose to use the stock King 2 Landing ski. And you have now finished the assembly of the fiber frame.

